



### Benefits

- Wet on wet application
- Rapid cure, average 30 minutes
- No primer required, except on porous substrates
- Minimum preparation required
- No reinforcement to acreage
- Can crack bridge & re-structure failing gutters
- Guarantees of 10, 15 and 20 years available

### Coverage Rates

#### 10 Year Guarantee System

1.25kg/m<sup>2</sup>  
(Polymat 225 at joints)

#### 15 Year Guarantee System

1.5kg/m<sup>2</sup>  
(Polymat 225 at joints)

#### 20 Year Guarantee System

2.0kg/m<sup>2</sup>  
(Polymat 225 throughout entire gutter)



Meir Roofing and Insulation Supplies supply all types of roof waterproofing systems to contractors, specifiers and clients across the whole of the UK from their base in the North of England. Whatever you require, from traditional roofing materials such as torch-on membranes, liquid waterproofing, mastic asphalt, insulation, sheeting and cladding, lead or copper, to green roofing or bio-diverse packages, we are able to help.

Our staff are experienced, highly trained and motivated personnel in all aspects of roofing and are there to help you whatever your requirement may be, large or small. We are committed to protecting the environment and purchase from renewable sources wherever possible.



#### LIQUID WATERPROOFING

Acrylic, Asbestos Encapsulation, Balcony Coat, Car Park, Cladding Coating, Roof light repair Refurbishment, Gutter lining

#### BITUMEN TORCH-ON MEMBRANES

APP, SBS and APAO modified, Self-adhesive, Heat activated, Anti-root, Tanking, Vapour barriers

#### MASTIC ASPHALT

Roofing, Flooring and Paving, Polymer Modified, Tanking

#### SINGLE PLY

PVC, TPO, EPDM Membranes, Trims and Termination Bars, Seaming Strips, Adhesives, Tools

#### INSULATION

PUR / PIR, Extruded Polystyrene, Expanded Polystyrene, Cut to Falls, Foamglass, Cement Topped XPS, Phenolic, Linear Fire stops, Acoustic Infill, Reflective Foil, Mineral Wool

#### GREEN ROOFS AND LIVING WALLS

Intensive, Extensive, Bio Diverse, Stud Membranes, Geotextiles, Paving Slabs, Drainage Mats

#### HOT MELT

Fully bonded hot melt system

#### PROMENADE AND WALKWAY

Glass Reinforced Concrete, Rubber Walkways, Paving Slabs, Equestrian and Playgrounds, Porous Concrete, PU Adhesive and Tile Spacers, Pave Pad Supports

#### SOLUTIONS

Bitumen Primers, Aluminium Paint, Solar Reflective Paint, Sealants, Polyurethane Adhesive

#### PROFILED SHEETING AND DECKING

Metal Sheeting, Tile or Slate Effect, Fibre Cement, Decking, Trims and Fixings, Roof lights, Barrel Vaults, Bitumen Corrugated Sheets, Flashings, Composite Panels

#### PITCHED ROOFING

Natural, Rubber and Fibre Cement Slates, Breathable and Non-Breathable Membranes, Architectural Ridge Tiles and Fittings, Velux Windows, Chimney Pots, Ventilation

#### SUNDRIES

Vents and Outlets, Lead Replacement Flashing, Trims and Edges, Protection Boards, Roof lights, Polythene Sheets, Radon Barriers, Methane Barriers

FOR MORE INFORMATION ON THE COMPLETE MEIR ROOFING RANGE CONTACT:

Unit C1, M62 Trading Estate, Larsen Road, Goole, East Yorkshire, DN14 6XF  
Tel:01405 780444 Fax:01405 780445 Email:sales@meir-roofing.co.uk



euro

POLYMERS GB

# Guttercote

Fast curing two part gutter system

October 2015



Before



After



- Wet on wet application
- Rapid cure, average 30 minutes
- No primer generally required
- Cures at low temperatures
- Minimum preparation required
- No reinforcement to acreage
- Can be applied to damp gutters
- Can crack bridge & re-structure failing gutters
- Guarantees of 10, 15 & 20 years available

# Guttercote

## Fast curing two part gutter system

Guttercote is a rapid curing gutter coating system which has been designed to be applied wet on wet. The entire system cures in 30 minutes and can be applied directly to rusted gutters without priming. Guttercote also benefits from 10, 15 and 20 year guarantees and warranties.

### Areas of application

- Galvanised metal
- Plastic
- Timber
- Concrete
- Zinc
- Metal
- Asphalt
- Bitumen
- Rusted metal
- Single ply
- Existing gutter fittings (peel test may be required)



Before



After

### Application Guide

#### Substrate preparation

Clean the substrate to be treated with a jet wash or other suitable means. Dry the surface area to be then treated, rag dry will usually be sufficient. Repair/replace any rusted through sections with suitable means. All lead surfaces should be thoroughly abraded prior to the system application with a wire brush.

#### Metal surfaces

Remove all proprietary repairs and friable loose rust using a 3000psi jet wash. Ensure that the existing bolts are secure and appropriately cropped. Sheets which are structurally unsound due to total corrosion particularly around fixings must be replaced or repaired.

#### Timber surfaces

Inspect timber gutter lining to ensure that the timber is structurally sound. Prime the dry timber gutter with **Europrime WB** at coverage of 0.25L/m<sup>2</sup>. A fully reinforced system should be applied to timber gutters using **Polymat 225** throughout.

#### Asphalt surfaces

Existing asphalt gutters should be sound, dimensionally stable, clean and free of loose matter and excess water. All cracks, gaps, holes should be raked out, suitably prepared and repaired by **Eurogard RPM (Repair Patch Mortar)**. Any hollows, blows or ridges in the existing substrate are to be ironed out to leave a smooth surface. Any cracks above 10mm should be repaired with **Eurogard RPM (Repair Patch Mortar)**.

#### Bituminous surfaces

Existing bitumen gutters should be sound, dimensionally stable, clean and free of loose matter and excess water. All cracks, gaps, holes should be raked out, suitably prepared and repaired. Any holes, blisters or ridges in the existing gutter substrate are to be repaired to leave a suitable surface. Any holes above 10mm should be repaired with **Guttercote** (fully reinforced) building up the thickness in preparation for full system application.

#### Lead surfaces

Inspect all lead gutter sheets, wire brush or mechanically abrade to form a key. Areas which are structurally unsound due to total erosion must be replaced with fully reinforced **Guttercote** building up the thickness to suit existing surface as the repair prior to system application.

#### Single ply surfaces

Existing single ply gutters should be sound, dimensionally stable, clean and free of loose matter and excess water. All rips, tears, holes should be cleaned, suitably prepared and repaired. Any exposed apertures above 10mm should be repaired by applying fully reinforced **Guttercote** building up the thickness to suit existing surface as the repair prior to system application.

#### Concrete surfaces

Existing concrete gutters should be sound, dimensionally stable, clean and free of loose matter and excess water. All cracks, gaps, holes should be raked out, suitably prepared and repaired. Any cracks above 10mm should be repaired with **Eurogard RPM (Repair Patch Mortar)**.

#### Priming

Mastic asphalt and bituminous surfaces do not usually require priming.

Concrete, timber, foreign coatings and existing GRP systems will require priming. Prime with **Europrime WB** at a coverage rate of 0.25L/m<sup>2</sup>.

An additional coat of primer may be required for extremely porous substrates, contact Euro Polymers Technical Support Team for details.

#### Mixing

**Guttercote** is supplied as two parts, a coloured liquid and pre-weighed catalyst component (There is no need to weigh any catalyst out with this system). Add the entire contents of the catalyst to the liquid in the tin and stir until the catalyst is no longer visible. Mix for approximately one minute.

#### Masking tapes

Masking tape should be applied to all adjacent junctions to the waterproofing system.

#### Gutter joints

Apply an initial coat of **Guttercote** over the gutter joints (with bond break applied) at a rate of 1.5kg/m<sup>2</sup> approximately 250mm over the fixings into the field area. Whilst wet embed the **Polymat 225** into the entire area of the wet membrane by applying gentle pressure with a short pile roller or brush. Ensure that the coating is applied to all fixing bolts and that the **Polymat 225** has wrapped around each. Remove any wicking prior to applying the main gutter coating.

#### Main gutter surface

Apply **Guttercote** over the entire gutter area including all joints and repairs. This coat should be applied at a minimum coverage rate of 1.25kg/m<sup>2</sup>. Pour the contents of the tin in quantities appropriate to the pre-gridded areas. Using a short pile roller spread out the product to a uniform thickness to achieve the required coverage rate. Refer to coverage rates section for specific details.

#### System limitations

This product must not be applied in standing water, freezing conditions are likely to occur before the membrane has dried. Once the system has been correctly mixed (see above) apply only at temperatures between -5°C and 40°C. MMA based products are rapid curing and typically cure within 30 minutes in normal working conditions.

#### System components

**Guttercote** – 1kg, 2.5kg, 5kg & 15kg units

**Europrime WB** – 5L & 15L units

**Polymat 225** – 250mm x 20m, 1m x 20m & 1.25m x 180m rolls

**Eurogard RPM (Repair Patch Mortar)** – 5kg & 10kg units



#### Step 1

Once clean, apply a minimum 50mm bond break to all gutter joint details.

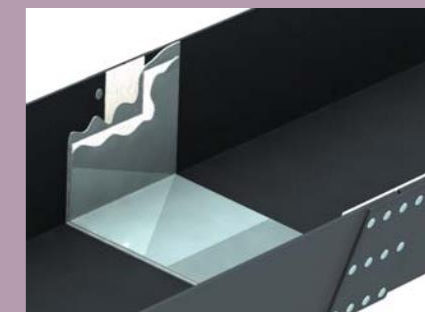

#### Step 2

To all gutter junctions apply 1kg/m<sup>2</sup> of Guttercote material. Into this embed Polymat 225, 125mm either side of the joint detail. Use a roller or brush to draw through the coating. While still wet apply a further 0.5kg/m<sup>2</sup> of Guttercote to fully encapsulate the detail.

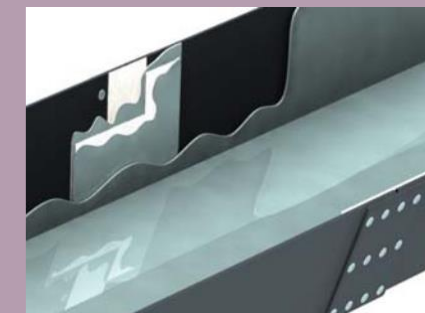

#### Step 3

Apply Guttercote material at the required coverage rate to the entire gutter area.