

MAXI Project

Apao Mineral Overlay

Sappi

NEW GENERATION APAO SINGLE LAYER MINERAL OVERLAY

Sappi Maxi Project single layer mineral overlay membranes are new generation APAO membranes, specifically formulated by Sappi to provide the ideal solution for reroofing of mineral finish roofs.

APAO COMPOUND TECHNOLOGY

“**Amorphous Poly-Alpha-Olefins**”, commonly known by their acronym as APAO are one of the most advanced modifiers used in modern modified bitumen membrane industry. APAO technology combines the best characteristics of Plastomers and Elastomers in one single product (ie: flexibility and adhesion of a good Elastomer; and heat resistance, UV stability, and chemical resistance of a top quality Plastomer). APAO polymers also provide the best anti-ageing properties, ensuring the longest possible life expectancy for a membrane roofing system in any weather conditions. APAO comes in different grades and types and careful blending and mixing is essential in order to obtain the desired performances and life expectancy of a bitumen compound and, therefore, of a bitumen based waterproofing membrane. 50 years of experience in manufacturing bitumen membranes have enabled Sappi to create a unique APAO compound which, combined with a superior, heavy duty polyester reinforcement, makes **Sappi Maxi Project** one of the best quality and most versatile modified bitumen membranes on the market.

FEATURES AND BENEFITS

Maxi Project Mineral Overlay membranes are simply “built stronger to last longer”, providing the best combination in terms of reinforcement, thickness, and compound formulation. After appropriate surface preparation, Maxi Project Mineral Overlay can be applied directly on the old existing roof, reducing both installation time and costs. No stripping of existing roof, therefore less risk of water ingress. No risks of exposure to potentially hazardous products in the old roof (eg. Asbestos or Tar). Less disruption to building’s occupants. Environmentally friendly: less landfill of old roof components. Less materials used, therefore: reduction in manual handling costs, reduction in transportation costs to site, reduction in packaging waste.

WIDE COLOUR RANGE

MAXI PROJECT MINERAL OVERLAY membranes are available in a range of several mineral colours. User friendly: Maxi Project Mineral Overlay membranes are quick and easy to apply thanks to their special APAO-Bitumen compound mix. After application, Maxi Project Mineral Overlay requires only minimal routine maintenance.

GUARANTEED QUALITY

MAXI PROJECT MINERAL OVERLAY membranes are 4 mm + Mineral for a 15 year guarantee and 5 mm + Mineral for a 20 year guarantee.

WARRANTIES

Established in 2004, **AWM** is one of the country’s leading construction risk and defect management companies. **AWM** offers a range of warranty options for new build, refurbishment and retrospective projects. Whatever your warranty needs, **AWM** has the option to suit you and your budget. When we identify problems, we pride ourselves on responding fast, minimising disruption to contractors and residents and delivering projects on time and on budget. Our expertise is well recognised throughout the UK and internationally, with **AWM** boasting a client roster ranging from blue-chip UK corporations right through to demanding multinationals and some of the biggest global insurance companies. To get full details about our warranty options please contact **AWM** head office.

Accreditations: **AWM** has full ISO Accreditation, 9001 – Quality Assurance, 14001 – Environmental, 27001 – Data Management. **AWM** has full ISO Accreditation, 9001 – Quality Assurance, 14001 – Environmental, 27001 – Data Management. **AWM** is also SafeContractor, Chas and Constructionline accredited, is also SafeContractor, Chas and Constructionline accredited.



Auditing Workmanship & Materials Ltd – Expresses Group Building
College Business Park – Kearsney Road – Ripon – HG4 2RN
t: 01765 603975 – f: 05602 092898 – m: 07903 654767
email: info@qaplus.org – web: www.qaplus.org

MAXI PROJECT RE-ROOFING SPECIFICATION EXAMPLES

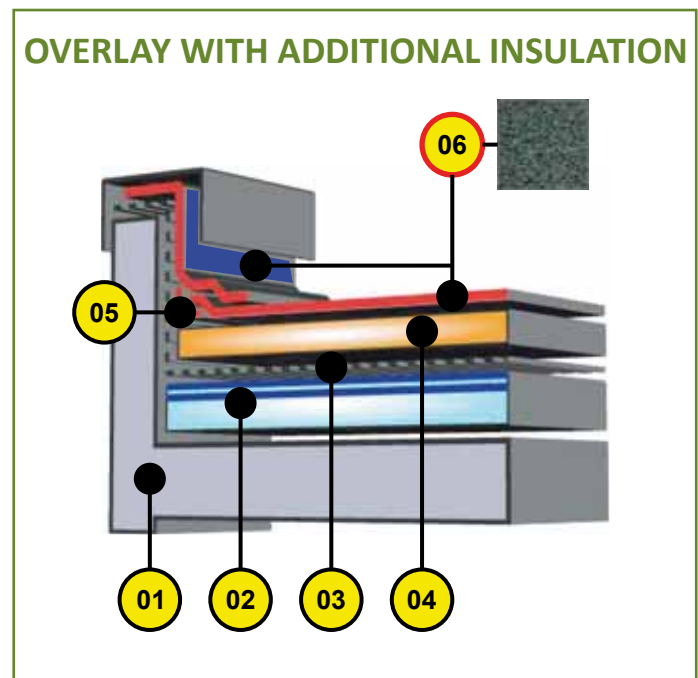
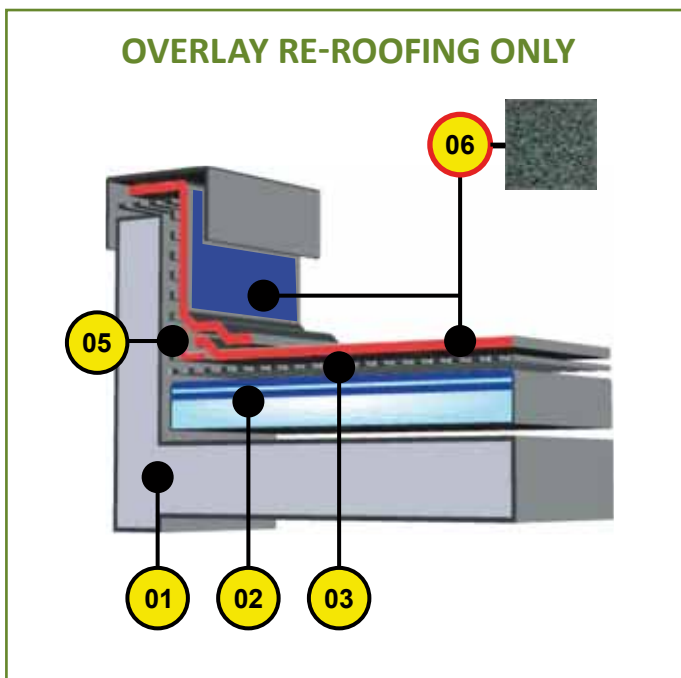

(01) deck - **(02)** existing waterproofing system: ensure that the existing waterproofing system is dry and securely attached to the deck support. If and when necessary: provide a suitable mechanical fastening system (even locally). Remove membranes from all the details. Cut and seal any blister and remove any loosely attached membrane. Incise all undulations and smooth them with mastic asphalt. Remove any piece of membrane from all details. If the external layer is mineral self-protected, saturate it with a bituminous primer - **(03)** priming: use a suitable, solvent based bituminous primer (for example our ViaBit). Application rate: 300÷500 gr/sqm approx. Saturate the external membrane face if mineral surfaced and allow to dry - **(04)** additional insulation board: use a suitable thermal insulation, mechanically fixed and/or glued to the existing waterproofing system - **(05)** 250÷330 wide corner reinforcement and connection strip, 4 mm thick, cut from an elastoplastomeric Sappi membrane, polyester reinforced, cold flex -10 °C or better, fully torched at the angle edges - **(06)** Viapol (Sappi) Maxi Project Mineral 4 (5) Overlay, elastoplastomeric polymer bitumen membrane, compound in distilled bitumen modified with APAO (Amorphous Poly Alpha Olefins) high molecular weight polymer, reinforced with nonwoven polyester fabric, glass stabilized, top face coated whit hot bonded slate granules. Field of Application : single layer mineral overlay, mineral cap sheet in a multy-layer waterproofing system. Method of Application: torched-on - Applicable Directive : EN 13707

..... BEFORE RENOVATION



..... AFTER RENOVATION



TECHNICAL DATA

Description: Description : elastoplastomeric polymer bitumen membrane, compound in distilled bitumen modified with APAO (Amorphous Poly Alpha Olefins) high molecular weight polymer, reinforced with nonwoven spunbond polyester fabric, glass stabilized, top face coated with hot-bonded slate granules.

Field of Application: single layer mineral overlay; mineral cap sheet in a multi-layer waterproofing system.

Method of Application: torched-on.

Applicable Directive: EN 13707.

Dangerous Substances: the product does not contain asbestos or tar.

Characteristic	EN DRC	UNIT	VALUE		TOL	
Visible Defects	EN 1849-1	–	pass		–	
Thickness (on selvedge)	EN 1849-1	mm	4 or 5		–10%	
Areic Mass	EN 1849-1	kg/m ²			npd	
Width and Length	EN 1848-1	m	1.0	7.50	–1%	
Straightness	EN 1848-1	mm	max 20		pass	
Max Tensile Force (L/T)	EN 12311-1	N/5cm	900	700	–20%	
Elongation (L/T)	EN 12311-1	%	45	45	–15 abs	
Resistance to Tearing (L/T)	EN 12310-1	N/5cm	160	160	pass	
Resistance to Static Loading	EN 12730-A	kg	20		pass	
Resistance to Impact	EN 12691	mm	1200		pass	
Joint Strength (L/T)	EN 12317-1	N/5cm			npd	
Peel Resistance of Joint	EN 12316-1	N/5cm			npd	
Pliability (Cold Flexibility)	EN 1109	°C	–20		pass	
Pliability (Aged)	EN 1296	°C			pass	
Uv Ageing (Visible Defects)	EN 1297	–	pass		–	
Watertightness	EN 1928	kPa	60		pass	
Water Vapour Permeability	EN 1931	μ × 1.000	20 (default)		npd	
Water Vapour Permeability (Aged)	EN 1296	μ × 1.000			npd	
Form stability (New/Aged)	EN 1110	°C	130	130	pass	
Dimensional Stability (L/T)	EN 1107-1	%	–0.25	+0.15	pass	
Root Resistance	EN 13948	–			npd	
External Fire Performance	EN 13501-5	class	F (roof)		npd	
Reaction to Fire	EN 13501-1	class	F		npd	
Adhesion of Granules (Mineral Version)	EN 12039	%	≤ 30		pass	
Pallet composition	Thickness	mm.	–	–	4	5
	Rolls × pallet	n.	–	–	20	16

Topside finish: slate chips/granules (mineral self-protection)

Underside finish: thermo-fusible polyethylene film

Packaging: shrinkable polyethylene film, on pallet

Additional info: "Polymer Bitumen Membrane Info Sheet", current release

4 mm plus mineral for a  15 years guarantee

5 mm plus mineral for a  20 years guarantee

Locally available from:

Technical data declared may vary without previous notice



Sappi a division of Vetroasfalto s.p.a. Via Pascoli, 3 - 20060 – Basiano (MI) ITALY
 phone +39 02.95983225 – fax +39 0295760225 – web: www.sappi.it – email: export@sappi.it
 Quality Assurance UNI EN ISO 9001:2008 – CE Certificate 0546/CPD 16876